

**1 WALL SECTION**  
OFFICE/STUDIO  
SCALE: 3/4" = 1'-0"

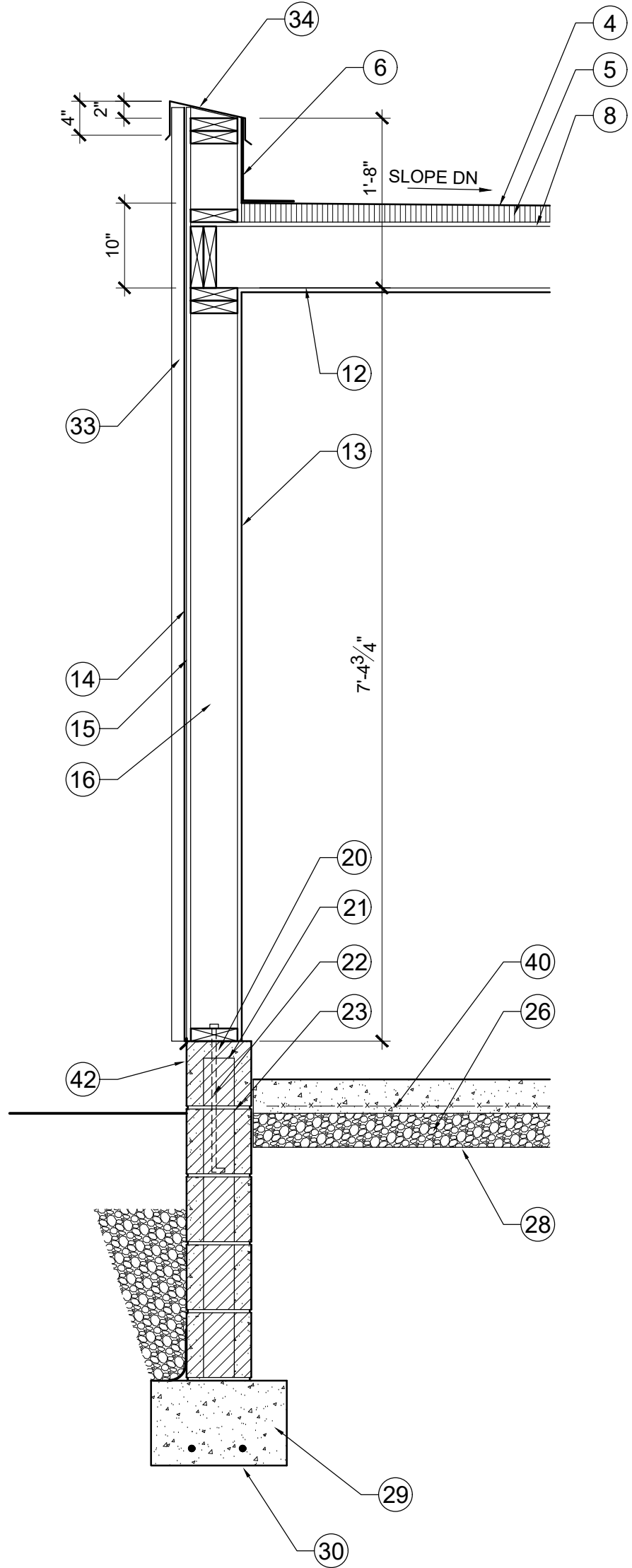

**2 WALL SECTION**  
STORAGE ROOM  
SCALE: 3/4" = 1'-0"

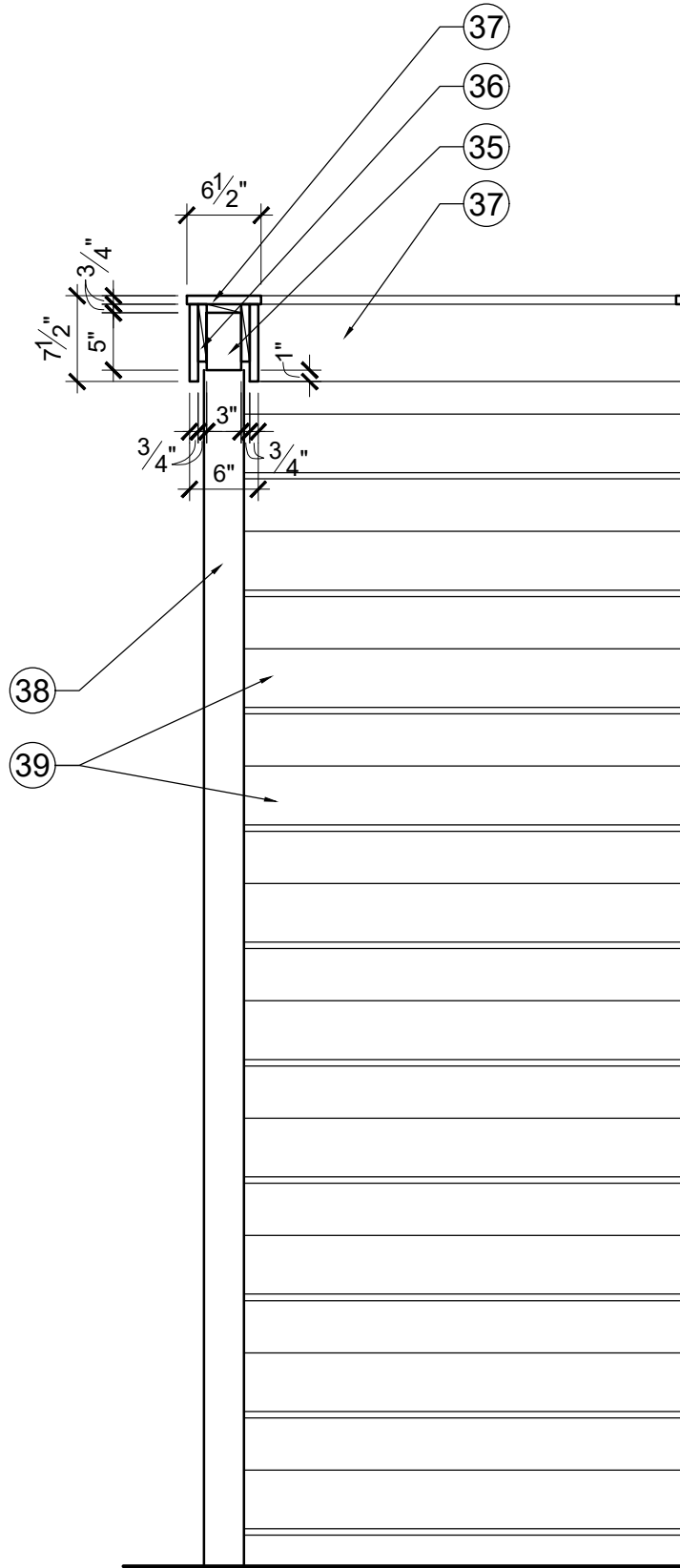

**3 DETAIL**  
SCREEN  
SCALE: 3/4" = 1'-0"

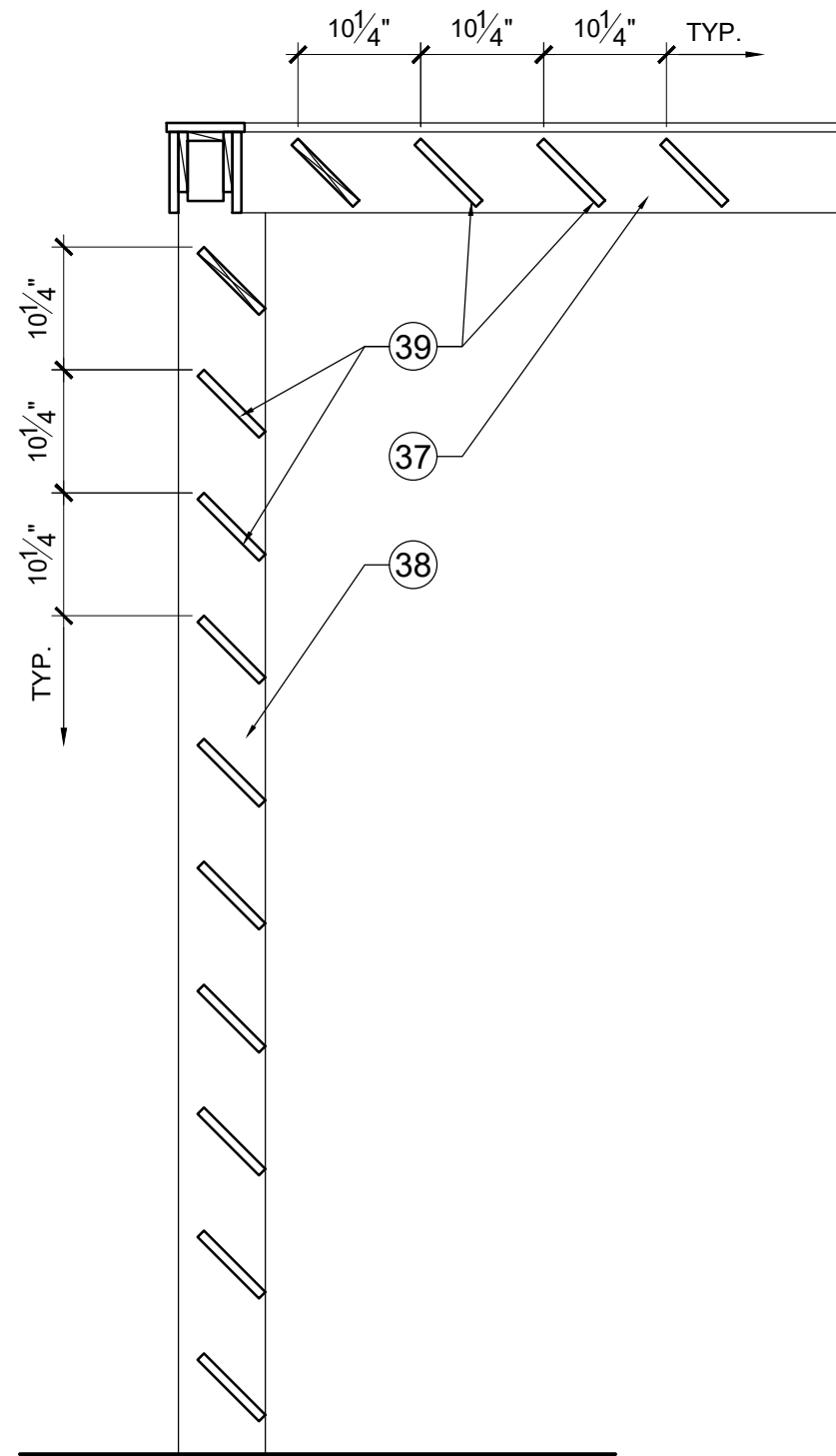

**4 DETAIL**  
SCREEN AND TRELLIS  
SCALE: 3/4" = 1'-0"

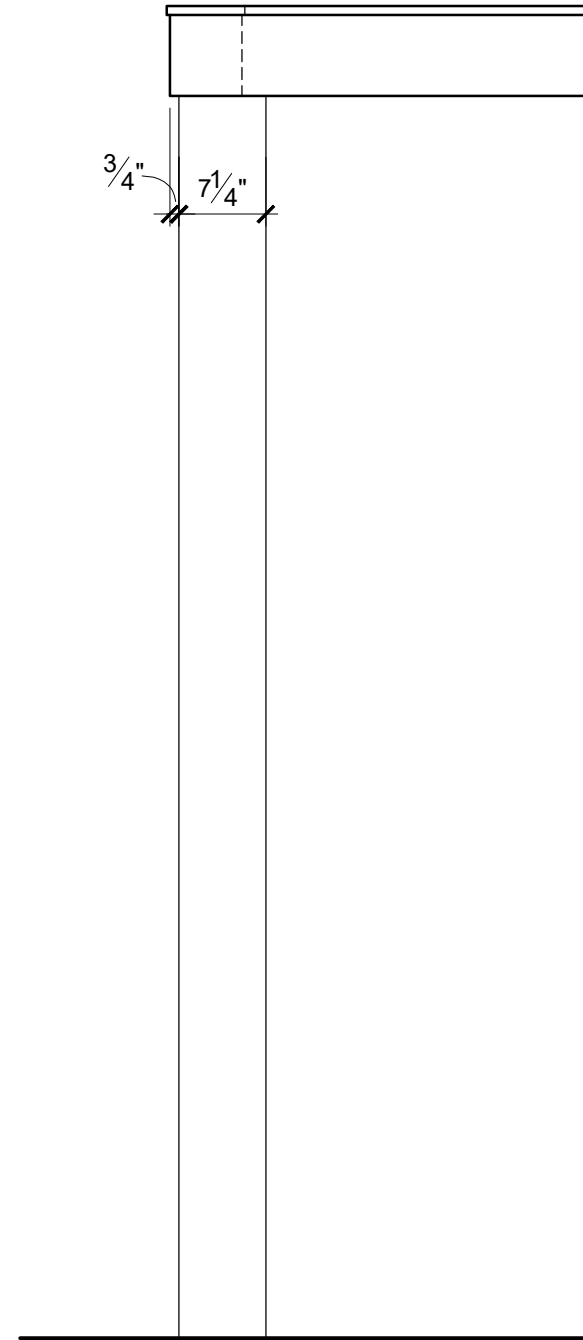

**5 DETAIL**  
COLUMN AND TRIMMED BEAM  
SCALE: 3/4" = 1'-0"

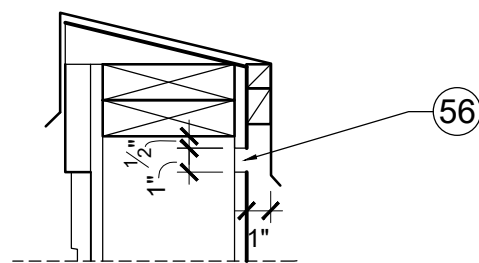

**6 DETAIL**  
PARAPET CAP AND VENT AT OFFICE/STUDIO  
SCALE: 1 1/2" = 1'-0"

- MATERIALS LIST**
1. PREFINISHED ALUMINUM COPING
  2. BLOCKING AS REQUIRED
  3. 5/4 WOOD TRIM WITH 2 1/2" EXPOSURE
  4. REINFORCED RUBBER MEMBRANE ROOFING
  5. TAPERED INSULATION
  6. REINFORCED RUBBER MEMBRANE FLASHING. EXTEND UP UNDER COPING
  7. CEMENT FIBER ARTISAN SIDING, SQUARE CHANNEL, 9" EXPOSURE
  8. BLIND NAILED, CORNERS MITERED
  9. 5/8" ROOF SHEATHING
  10. AIR SPACE
  11. R-38 INSULATION
  12. 2X12 CEILING JOISTS, 24" O.C.
  13. 5/8" GYPSUM WALLBOARD (CEILINGS)
  14. 1/2" GYPSUM WALLBOARD
  15. WATER RESISTANT, BREATHABLE, AIR BARRIER, TYVEK HOMEWRAP OR EQUAL
  16. 1/2" WALL SHEATHING
  17. 2X6 STUDS @ 16" O.C.
  18. R-21 FIBERGLASS BATT INSULATION WITH VAPOR RETARDER
  19. 3/4" T&G PLYWOOD SUBFLOOR GLUED AND NAILED
  20. 2X10 FLOOR JOISTS @ 16" O.C.
  21. 2X6 TREATED WOOD PLATE
  22. FIBERGLASS SILL SEAL
  23. 1/2" DIAMETER ANCHOR BOLT, 1'-6" LONG, EMBEDDED AT LEAST 1'-3" DEEP, 6'-0" O.C. AND NOT MORE THAN 1'-0" FROM ANY CORNER
  24. 8X8X16 C.M.U. TERMITE BLOCK
  25. 8X8X16 C.M.U.
  26. R-13 INSULATION DRAPE
  27. VAPOR BARRIER, 6 MIL. POLY
  28. EXTEND VAPOR BARRIER UP WALL. SECURE TO WALL WITH CONTINUOUS SEALED ATTACHMENT
  29. GRAVEL 4"
  30. 10X16" CONCRETE FOOTING
  31. 2 #5 REINFORCING BARS
  32. DAMPPROOFING PER CODE REQUIREMENTS
  33. GRAVEL BACKFILL TO WITHIN 1'-0" OF GRADE
  34. PREFINISHED DOUBLE LOCKED STANDING SEAM METAL PANEL. PANELS 16" WIDE
  35. PREFINISHED METAL COPING. MATERIAL OF COPING TO BE COMPATIBLE WITH MATERIAL OF WALL PANEL
  36. HSS 5" X 3" X 5/16" STEEL TUBE
  37. 1X WOOD TRIM
  38. 4X8 COLUMN
  39. 1X8
  40. 4" CONCRETE SLAB WITH 6X6, W1.4/W1.4 WWF
  41. WALL FLASHING
  42. FLASHING BY STANDING SEAM METAL PANEL MANUFACTURER
  43. W8X18 STEEL BEAM. SEE STRUCTURAL INFORMATION FOR THE ALL HARDWARE AND ASSEMBLY DETAILS
  44. PREFINISHED DOUBLE LOCK STANDING SEAM METAL PANEL ROOFING. PANELS 16" WIDE
  45. 30# ROOFING FELTS
  46. PREFINISHED METAL DRIP EDGE. COMPATIBLE WITH METAL ROOFING
  47. 1X WOOD FASCIA TO MATCH AND ALIGN WITH EXISTING
  48. 2X SUBFASCIA
  49. PREFINISHED OGEE PROFILE GUTTER TO MATCH AND ALIGN WITH EXISTING
  50. 2" CONTINUOUS SOFFIT VENT
  51. SOFFIT MATERIAL TO MATCH EXISTING
  52. 1X TRIM BAND TO MATCH AND ALIGN WITH EXISTING
  53. 1X BLOCKING
  54. 5/4 X 6 V GROOVE DECKING
  55. BLOCKING AS REQUIRED
  56. CONTINUOUS VENT SLOT WITH CORROSION RESISTANT SCREEN
  57. 1" DIAMETER AIR HOLE. 3 PER JOIST SPAN

COPYRIGHT 2021  
THE DRAWINGS, SPECIFICATIONS AND OTHER DOCUMENTS  
GENERATED SHALL REMAIN THE PROPERTY OF GARY J.  
ALEXANDER, ARCHITECT AND MAY NOT BE USED, DUPLICATED,  
OR ALTERED, WITHOUT WRITTEN CONSENT OF THE ARCHITECT.

ADDITIONS TO THE  
THE MUGLER RESIDENCE  
2562 BEXLEY PARK RD

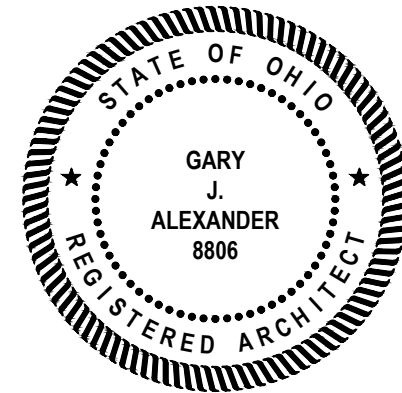

Gary J. Alexander,  
Architect  
1265 Neil Avenue, Columbus, Ohio 43201  
(614) 487-0637

PRICING: 02-25-2021

A-7