

FOUNDATION NOTE:

GENERAL CONTRACTOR TO PROVIDE TWO BIDS FOR OPTIONS:

A) PIER FOOTING AT OUTSIDE COLUMN LOCATION, AND TREATED WOOD FLOOR STRUCTURE WITH SYNTHETIC DECKING

B) FULL CONCRETE BLOCK FOUNDATION WITH POURED CONCRETE SLAB FLOOR

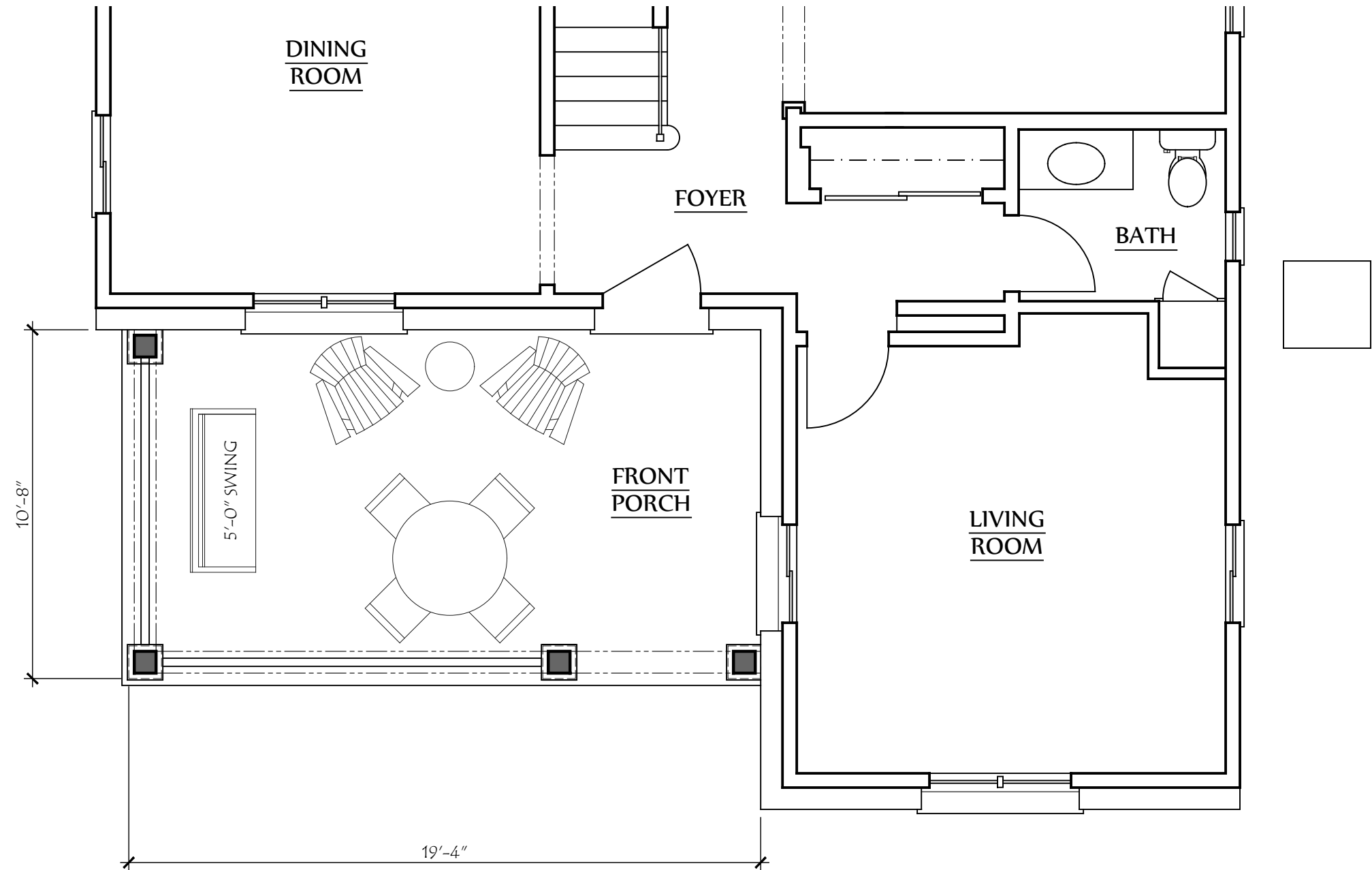

COPYRIGHT©

LAUERHASS ARCHITECTURE, LLC
ALL RIGHTS RESERVED.

THE ARCHITECT'S DRAWINGS AND OTHER WORK ARE FOR USE SOLELY ON THIS PROJECT. THE ARCHITECT IS THE AUTHOR, AND RESERVES ALL RIGHTS. INFORMATION CONTAINED HEREIN SHALL NOT BE USED WITHOUT THE EXPRESS WRITTEN AUTHORIZATION OF THE ARCHITECT.

<u>Date:</u> 18 May 2020	<u>Drawing Title:</u> Porch Plan	<u>Scale:</u> 1/4" = 1'-0"
<u>Project Number:</u> 18-019	<u>Project Name:</u> The Kim Residence	<u>Sheet Number:</u> A-1

Lauerhass Architecture
RENOVATION - ADDITION - NEW HOME



COPYRIGHT©

LAUERHASS ARCHITECTURE, LLC
ALL RIGHTS RESERVED.

THE ARCHITECT'S DRAWINGS AND OTHER WORK
ARE FOR USE SOLELY ON THIS PROJECT.
THE ARCHITECT IS THE AUTHOR, AND RESERVES
ALL RIGHTS. INFORMATION CONTAINED HEREIN
SHALL NOT BE USED WITHOUT THE EXPRESS
WRITTEN AUTHORIZATION OF THE ARCHITECT.

Date:
18 May 2020

Project Number:
18-019

Drawing Title:
Elevations

Project Name:
The Kim Residence

Scale:
3/16" = 1'-0"

Sheet Number:
A-2



Lauerhass Architecture
RENOVATION - ADDITION - NEW HOME