





























662







SCALE: 1 inch = 20 Ft.
(when printed on 11x17 inch paper)

Site Plan

662 Vernon Road
Bexley, Oh 43209

July 18, 2024

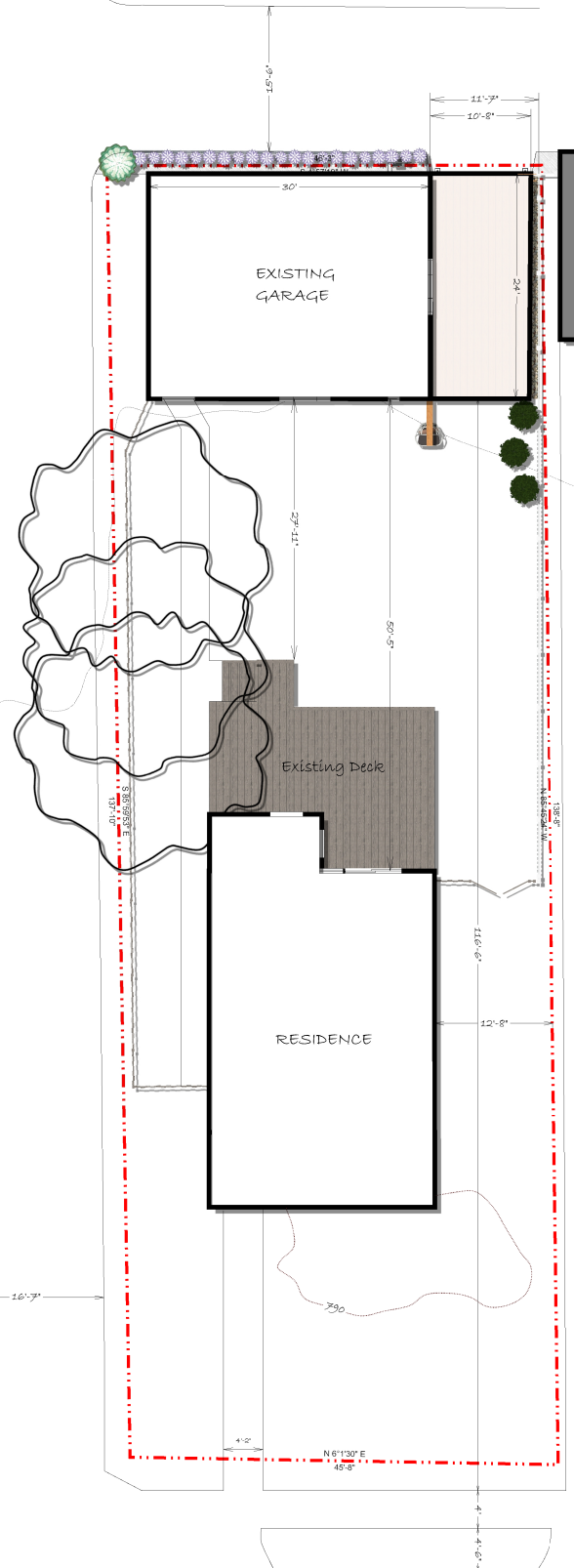

Design by:
Ryan Brothers' Landscaping
 1239 Stimmel Rd.
 Columbus, OH 43223
 Phone Number: 614-800-2279
 E-mail: www.ryanbrotherslandscaping.com

Additional Lot Coverage:
 Lot: 6,350 Square Feet
 House: 902 Square Feet
 Garage: 692 Square Feet
 Walkways: 400 Square Feet
 Deck: 370 Square Feet
 New Garage Addition: 260 Square Feet
 Total: 2,624 Sq. Ft. (41.32%)

Project Goal:
 The homeowner at 662 Vernon Road is looking to achieve another off street parking spot since the streets in South Bexley are relatively narrow.

Project Description:
 We will be adding roughly a 260 square foot broom finish concrete parking pad that will exist roughly 1' from the existing vinyl fence.

The constructed lean-to roof over the concrete pad will be structurally tied into the existing garage

Posts will be 6" x 6" treated posts wrapped with cedar sunk below frost line at 32" with 12" wide footers for structural support

Ceiling will be constructed of tongue and groove cedar and will have 4-6 recessed lights

There will be a full wall (t/g Cedar) and garage door (Tempered Glass Panel) on the alley side of the existing garage











SCALE: 1 inch = 20 Ft.
(when printed on 11x17 inch paper)

Site Plan

662 Vernon Road
Bexley, Oh 43209

Revised on:
July 30, 2024

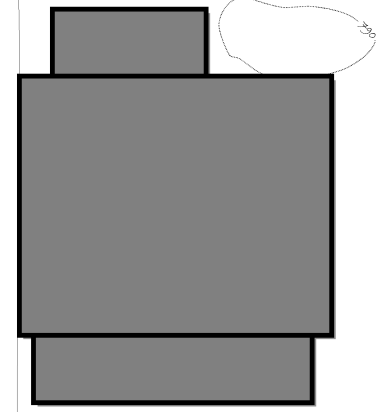
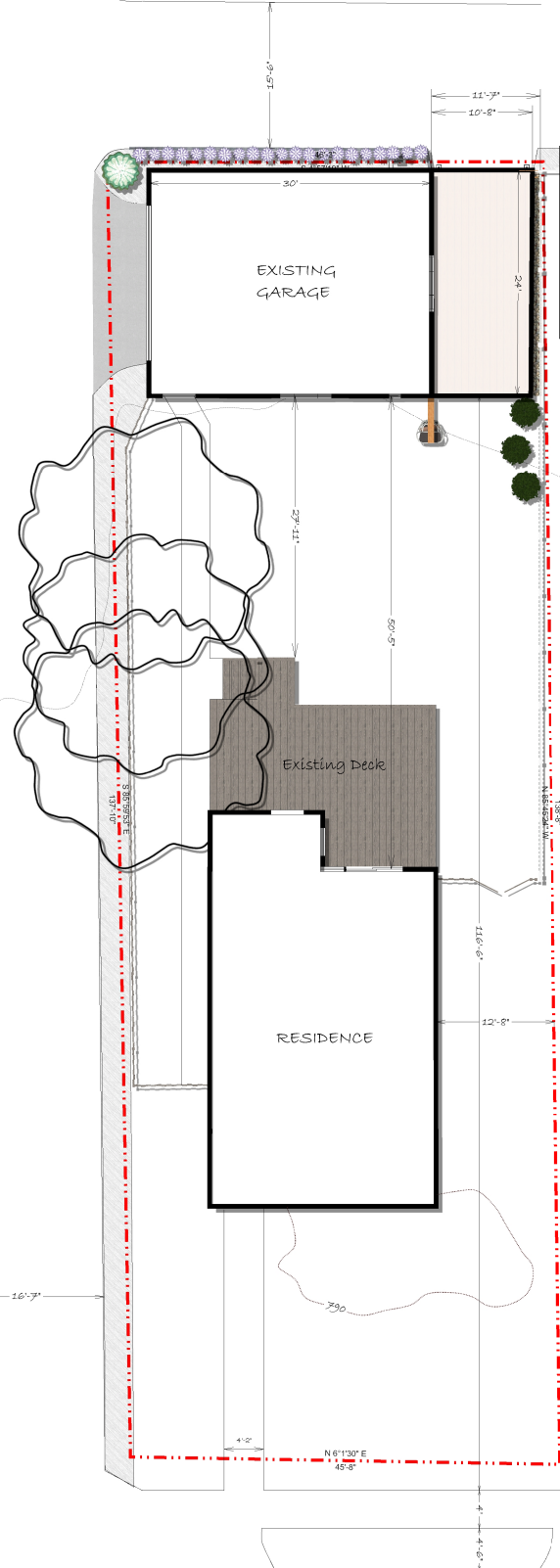
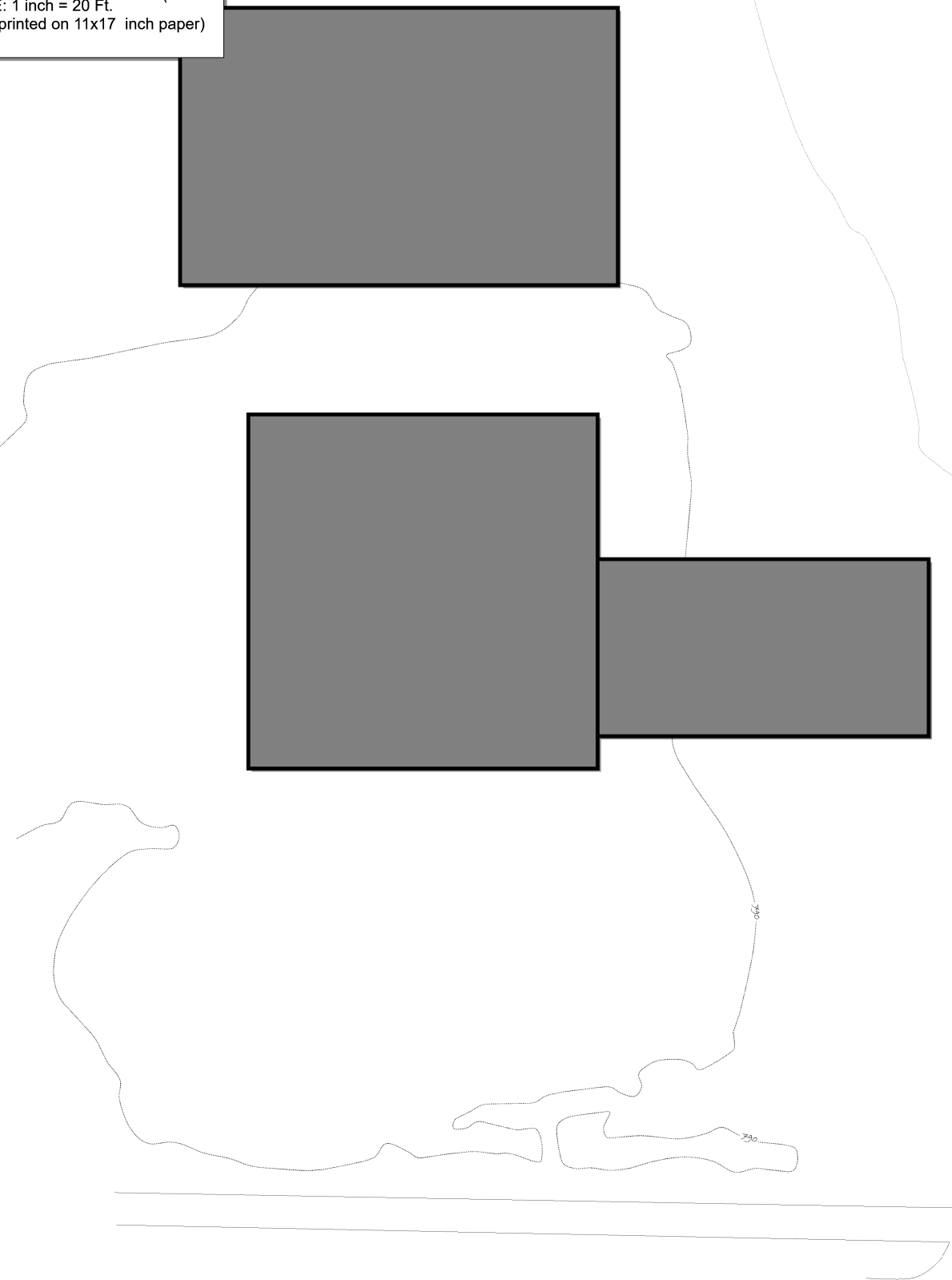

Project Goal:

The homeowner at 662 Vernon Road is looking to achieve another off street parking spot since the streets in South Bexley are relatively narrow.

Project Description:

We will be adding roughly a 260 square foot broom finish concrete parking pad that will exist roughly 1' from the existing vinyl fence.

The constructed lean-to roof over the concrete pad will be structurally tied into the existing garage

Posts will be 6" x 6" treated posts wrapped with cedar sunk below frost line at 32" with 12" wide footers for structural support

Ceiling will be constructed of tongue and groove cedar and will have 4-6 recessed lights

There will be a full wall (t/g Cedar) and garage door (Tempered Glass Panel) on the alley side of the existing garage

Additional Lot Coverage:

- Lot: 6,350 Square Feet
- House: 902 Square Feet
- Garage: 692 Square Feet
- Walkways: 400 Square Feet
- Deck: 370 Square Feet
- New Garage Addition: 260 Square Feet
- Total: 2,624 Sq. Ft. (41.32%)

Design by:
Ryan Brothers' Landscaping

1239 Stimmel Rd.
Columbus, OH 43223
Phone Number: 614-800-2279
E-mail: www.ryanbrotherslandscaping.com



SCALE: 1 inch = 20 Ft.
(when printed on 11x17 inch paper)

Site Plan

662 Vernon Road
Bexley, Oh 43209

July 18, 2024

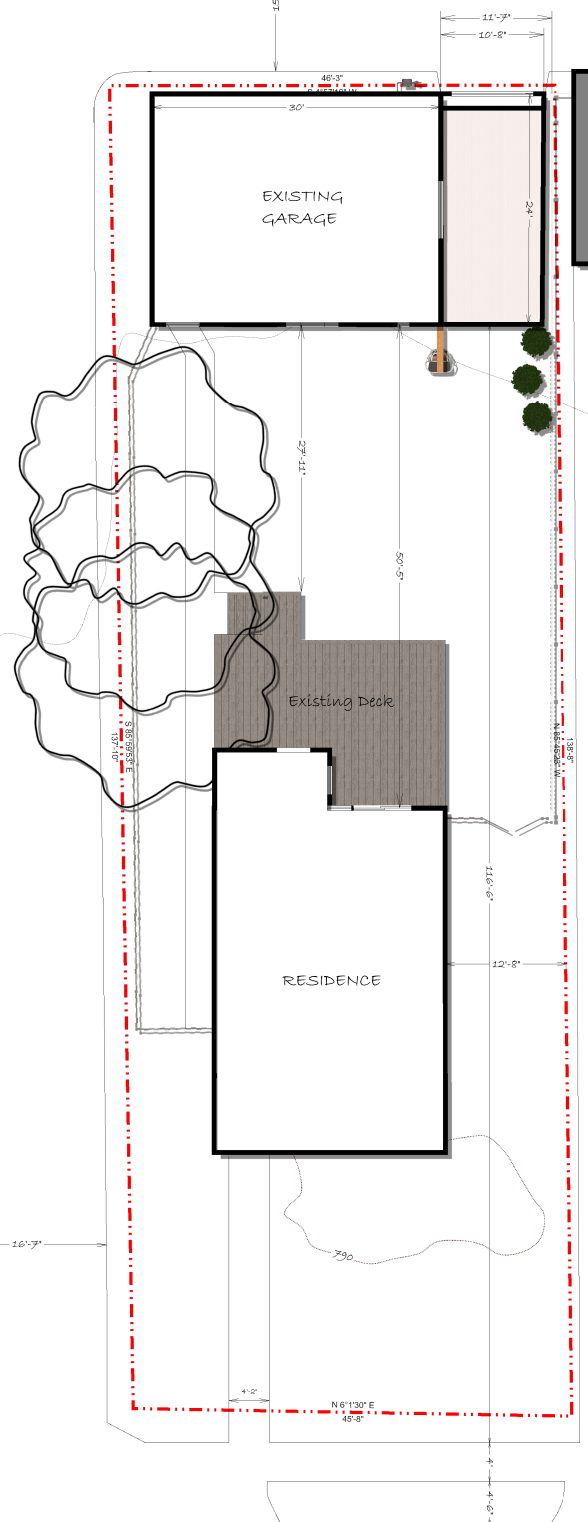

Project Goal:

The homeowner at 662 Vernon Road is looking to achieve another off street parking spot since the streets in South Bexley are relatively narrow.

Project Description:

We will be adding roughly a 260 square foot broom finish concrete parking pad that will exist roughly 1' from the existing vinyl fence.

The constructed lean-to roof over the concrete pad will be structurally tied into the existing garage

Posts will be 6" x 6" treated posts wrapped with cedar sunk below frost line at 32" with 12" wide footers for structural support

Ceiling will be constructed of tongue and groove cedar and will have 4 recessed lights

There will be a full wall and garage door on the alley side of the existing garage

Additional Lot Coverage:

Lot: 6,350 Square Feet
 House: 902 Square Feet
 Garage: 692 Square Feet
 Walkways: 400 Square Feet
 Deck: 370 Square Feet
 New Garage Addition: 260 Square Feet
 Total: 2,624 Sq. Ft. (41.32%)

Design by:
Ryan Brothers' Landscaping
 1239 Stimmel Rd.
 Columbus, OH 43223
 Phone Number: 614-800-2279
 E-mail: www.ryanbrotherslandscaping.com